

Front Auditorium Floorplan

KEY DIMENSIONS

| | |
|-------------------|----------------------------------|
| Stage | 8m x 4m & 450mm high |
| Full space: | 18m x 20m |
| Front half space | 18m x 10m + stage alcove |
| Rear half space | 18m x 10m |
| Terrace: | 8m & 18m wide at ends x 20m long |
| Ceiling height: | 3590mm (bulkhead to floor) |
| | 1420 (bulkhead to ceiling) |
| | 4990 (ceiling to floor) |
| Foyer Doorways: | 2035 high x 1580 wide (mm) |
| Terrace Doorways: | 2075 high x 1700 wide (mm) |

APPROXIMATE SCALE (1cm = 2m)



North

LEGEND

P = power points - double 240V on wall or 4x 240V in floor wells

D = data point

Stage = 12 sections 1.2m x 2m 450mm each (20 sections available and 300mm legs also)

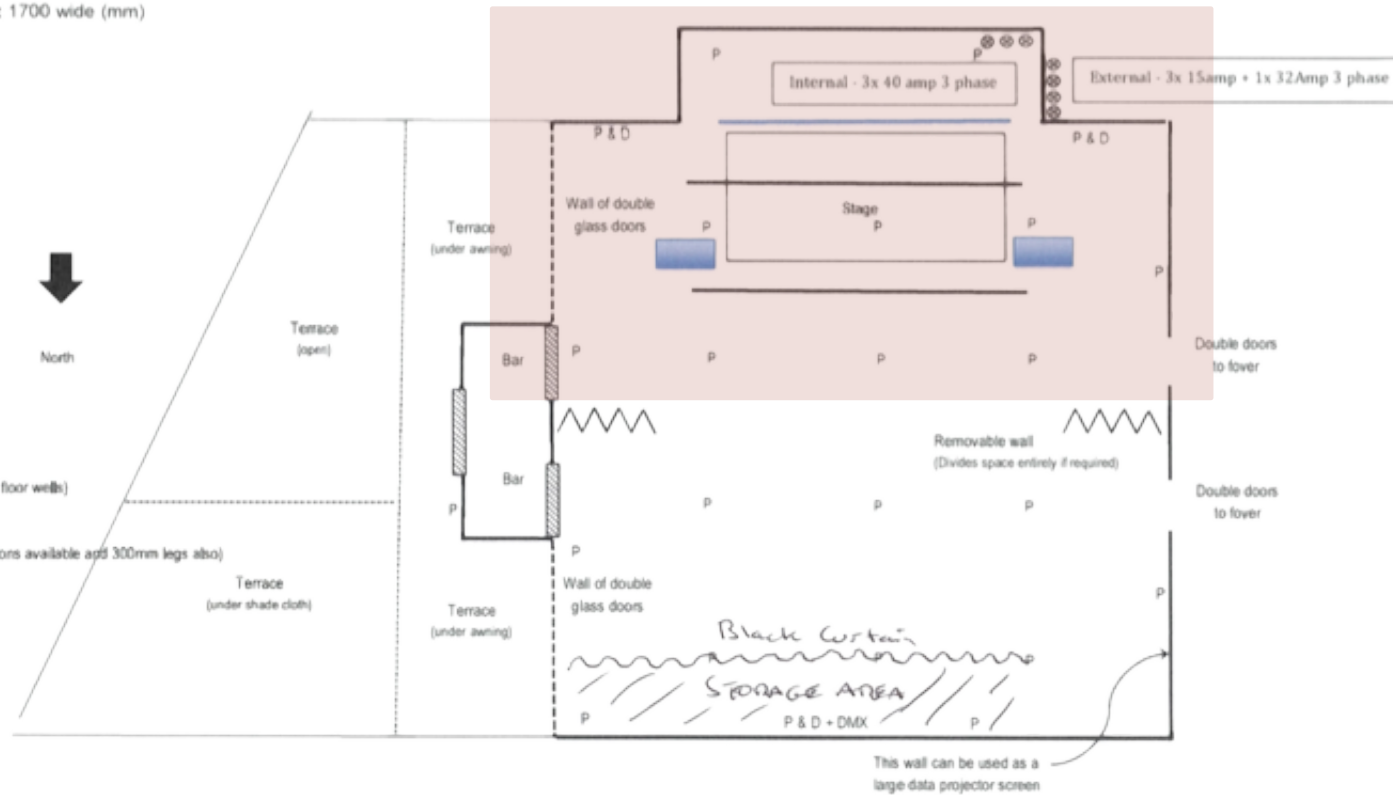

 JBL PRX625 Powered Dual 15" speaker (x 4) JBL PRX618S Powered 18" Subwoofer (x 3)

LX bar boxed steel - Front of stage has electrics installed (12 points) - solid removable wall behind stage with a standard door either side, small kitchen backstage.