

Rear Auditorium Floorplan

KEY DIMENSIONS

Stage	8m x 4m & 450mm high
Full space:	18m x 20m
Front half space	18m x 10m + stage alcove
Rear half space	18m x 10m
Terrace:	8m & 18m wide at ends x 20m long
Ceiling height:	3590mm (bulkhead to floor)
	1420 (bulkhead to ceiling)
	4990 (ceiling to floor)
Foyer Doorways:	2035 high x 1580 wide (mm)
Terrace Doorways:	2075 high x 1700 wide (mm)

APPROXIMATE SCALE (1cm = 2m)



North

LEGEND

P = power points - double 240V on wall or 4x 240V in floor wells

D = data point

Stage = 12 sections 1.2m x 2m 450mm each (20 sections available and 300mm legs also)

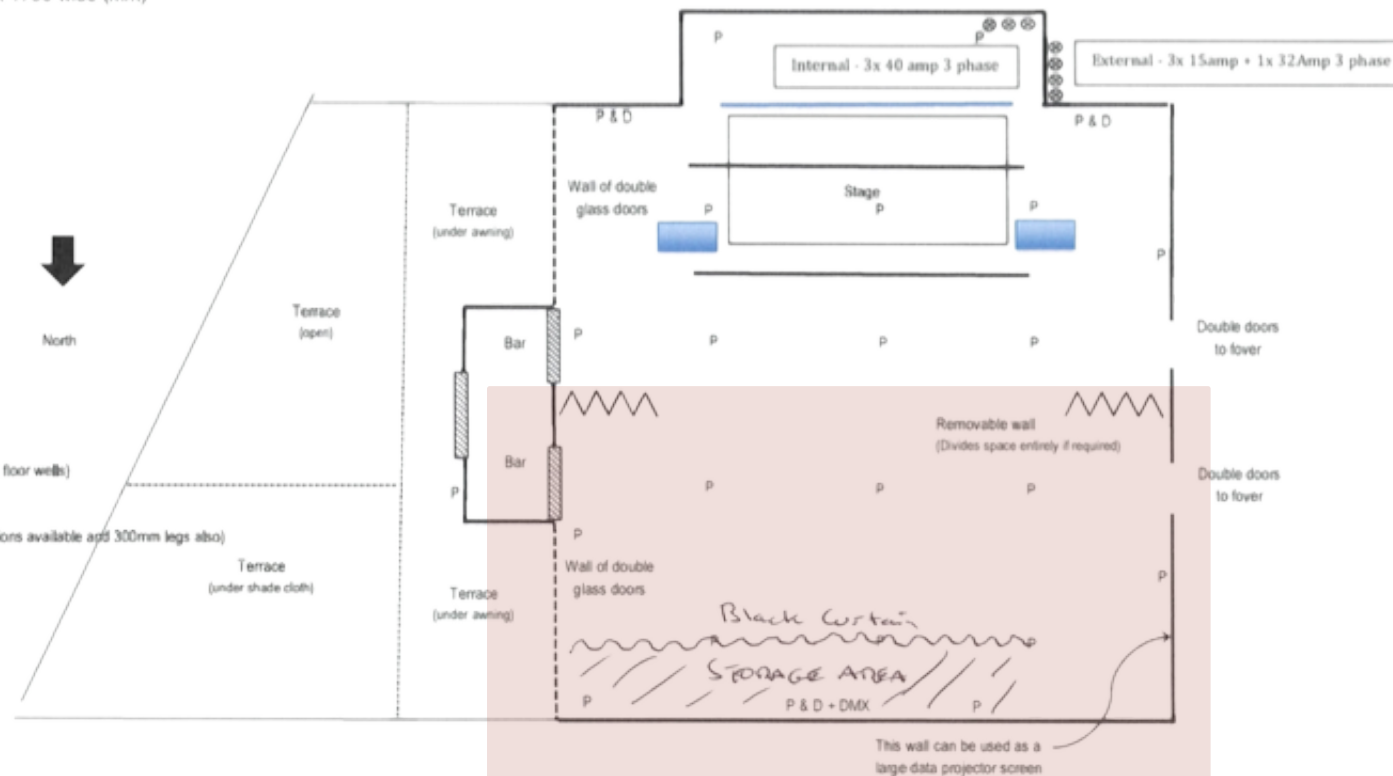

 JBL PRX625 Powered Dual 15" speaker (x 4) JBL PRX618S Powered 18" Subwoofer (x 3)

LX bar boxed steel - Front of stage has electrics installed (12 points) - solid removable wall behind stage with a standard door either side, small kitchen backstage.